

# Technical datasheet

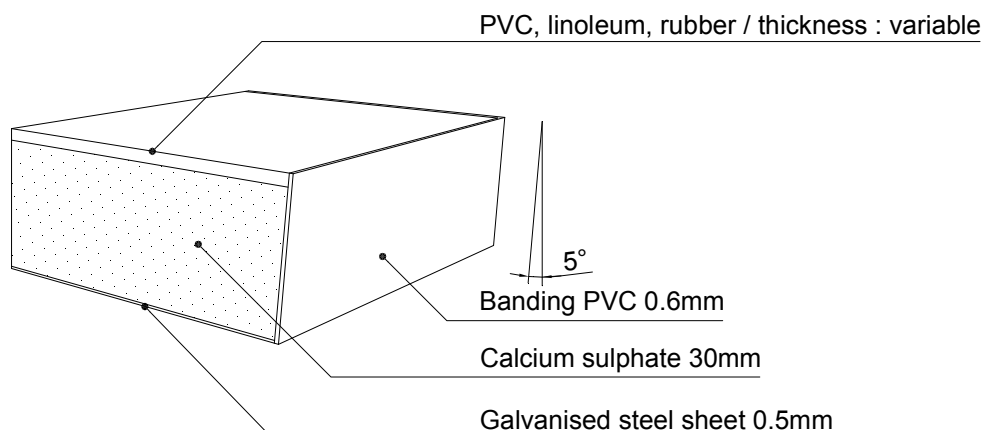

## 30 GSB-P

Tested according the European norm 12825

### General characteristics

|              |   |  |
|--------------|---|--|
| Measurements | : | 600 x 600 mm   |
| Weight       | : | +/- 17,5 kgs   |
| Core         | : | 30 mm Calcium Sulphate Knauf - density 1500 kgs/m <sup>3</sup> |
| Bottom side  | : | Galvanised steel 0,5 mm  |
| Upper side   | : | Covered with PVC, linoleum or rubber                           |
| Edge banding | : | PVC 0,6 mm   |

### System characteristics

|  |   |                            |
|--|---|----------------------------|
| Class of element                                       | : | 2                          |
| Ultimate load  | : | ≥ 6 kN                     |
| Safety factor  | : | 2                          |
| Point load<br>(= ultimate load/safety factor)          | : | 3 kN                       |
| Class of deflection<br>(max 2,5mm deflection by 3Kn)   | : | A                          |
| Divided load per m <sup>2</sup><br>(Theoretical value) | : | 15kN–20kN / m <sup>2</sup> |

### Fire characteristics

|                 |   |                               |
|-----------------|---|-------------------------------|
| Fire resistance | : | F30 according DIN 4102-2      |
| Fire reaction   | : | Class A2 according DIN 4102-1 |

### Electrical resistance

10<sup>7</sup> - 10<sup>10</sup>Ω

Other values are possible by the use of conductive banding and conductive glue.

complete certificates on request

Jansen Products NV

Fabriekstraat 4  
3670 Meeuwen  
BELGIUM

Tel : +32 11 79 33 00  
Fax: +32 11 79 33 01  
info@jansenproducts.be  
www.groupjansen.com